

## RAS - Shade Operation and Cleaning Motorized

### Lowering the Shade

Press the button on the left with the down arrow to lower the shades. If there is a specific desired length press the stop button (above the up/down controls) when at the length.

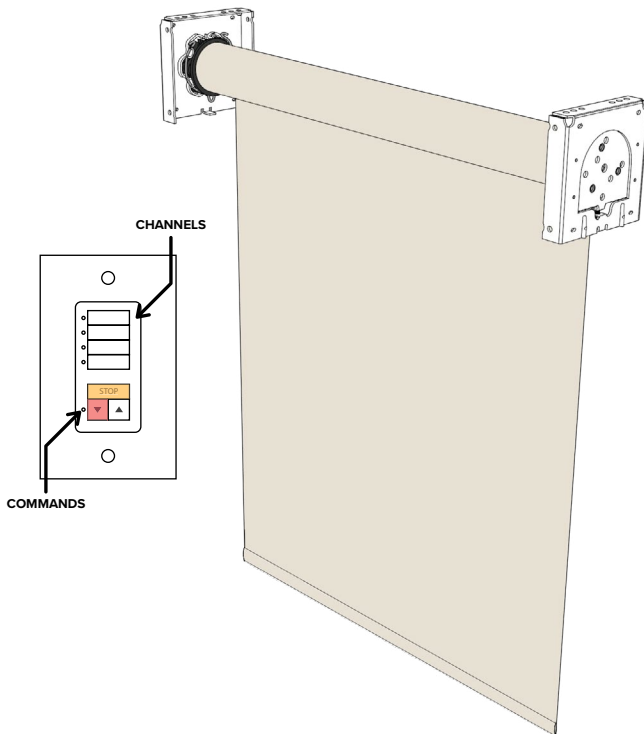

### Raising the Shade

Press the button on the right with the up arrow to raise the shades. If there is a specific desired length press the stop button (above the up/down controls) when at the length.

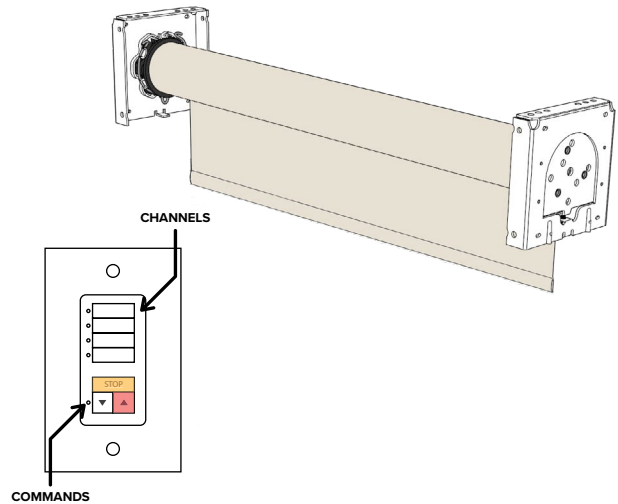

## Warnings

- Limits are set on the shades causing them to raise or lower to a comfortable length. Do not try to raise or lower the shades past this as it may damage the shade or remote.
- Pulling the bottom of the shade may damage the motor, brackets or shade, which can cause the shade to become inoperable.

## Recommended Cleaning Methods

### Cleaning the Shade Material

- Dusting: Regular dusting maintains a like-new appearance of shades.
- Vacuuming: For deeper cleaning, vacuum gently with brush attachment.
- The best method of cleaning is by regular washing of the fabric using a solution of warm water and mild detergent. Removing window shades may void manufacturer's warranty and or damage the motors
- It is recommended that cleaning occurs at a time of day that allows the shades to dry while in the "down" position (overnight).