

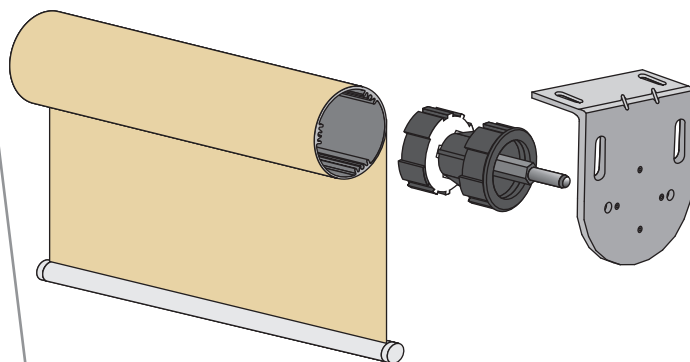

# 110 VOLT MOTORIZED SHADE SYSTEMS



## SONESSE™

- Motors are Ultra Quiet
- 35 in./lb torque

## ALTUS™

- Superior lifting capabilities
- 52 - 440 in./lb torque
- Shades are powered by a line voltage AC Motor
- Available with a power cord or can be hardwired
- Works with Link System (Pg 17), 4" Fascia System (Pgs 13, 14) or Contract Series (Pg 18)

Roll-A-Shade's Motorized Systems are a wonderful addition to any of our shade systems and makes shade operation trouble free. These can be setup to lift all shades individually or in unison for a clean uniform look. They are also a great way to lift heavy shades without effort or for operation of those hard to reach shades. No dangling cords ensuring a clean appearance.

### WALL OR INSIDE MOUNT

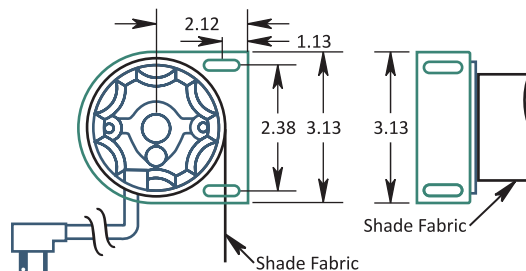

### CEILING MOUNT

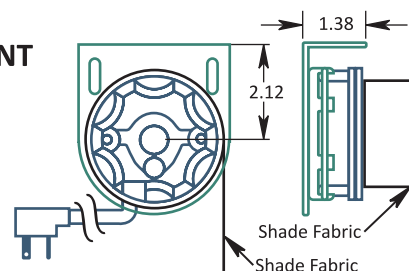

### END PLUG & BRACKET WITH RETAINER

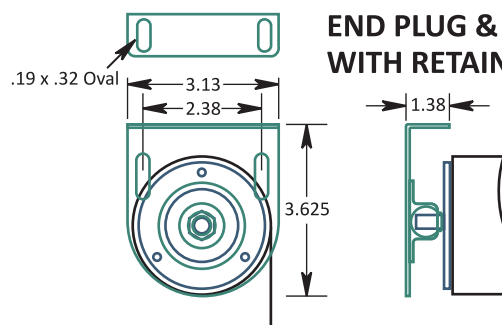

#### Technical Data:

- 110 Volt AC tubular-type directional motor designed specifically for roller shade systems.
- Motors includes built-in limit and thermal overload switches.